



Our island kitchen models have been engineered for extreme functionality & luxury to provide years of enjoyable meal preparation and memorable dining experiences. Standard features include premium solid surface countertops, hidden hinges, cherry wood, deluxe valances, day/night shades and a fireplace to name a few.

Tall cabinets with 20% more storage than previous model



The optional sectional sofa delivers that "home feel" with style and comfort.



Movie night with family and friends? Kick back in comfort in the den room, watch that favorite flick.

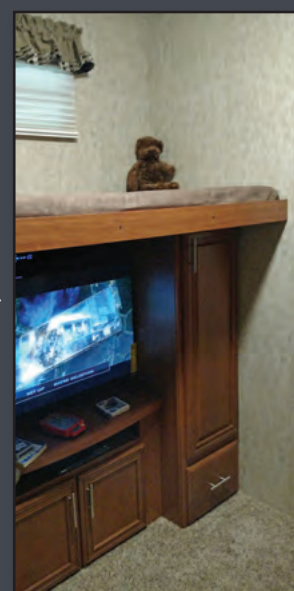

New Dry Bar with wine rack adds storage and functional space for entertaining. Dual tone cabinetry available in all floorplans for 2019.

New Theater/ Bunk Room available with half bath to create a private haven just for the kids!



## BRIDGEVIEW STANDARD FEATURES

### Exterior Features

- Detachable Hitch
- 96" Floor Width
- 96" Ceiling Height
- 2- 5,200 Axles (35' - 44' Units)
- Front Bay Window
- Two (2) 30 LB Bottles with Regulator
- Manual Flush Push Outts
- Atrium Windows
- Patio Door (Thermo Pane) With Grids
- Deluxe LOGO and Graphics
- Tinted Radius Windows with Black Trim
- 1 Piece Fiberglass Front
- Premium Grade Roof Membrane with 10 Yr. Manufacture Limited Warranty

### Kitchen and Bath

- Center Kitchen
- 1 pc. Fiberglass Tub/Shower
- Acrylic Sink
- Maple Raised Panel Doors OH (Glazed Finish)
- Deluxe Medicine Cabinet with Mirror
- Contrasting accent walls in slide rooms
- Deluxe Sofa Cabinet (Angled Corners)
- Residential Style Toilet
- All Bath Hardware and Fixtures
- Full Extension Ball Bearing Drawer Glides
- Solid Wood Cabinet Doors (Glazed Finish)
- Deluxe Hidden Hinges
- Power Bath Vent with Switch
- Hi Bead Profile Doors w/ 7 Step Finish Process
- Porcelain Vanity Sink
- Premium Granite-Look Laminate
- Adjustable Pantry Shelves
- Hidden Hinges



### Interior Features

- Table and Four (4) Chairs
- Sofa Standard
- Queen Bed
- Flat Floor (No Wheel Wells)
- Mini-Blinds
- White Ceiling
- Vertical Blinds (Side Patio Door)
- Linoleum Kitchen and Bath
- Bed Spread
- Bath Fixtures (Per Print)
- Pantry Shelf Kitchen and Bath
- Hi Efficiency LED Lighting
- Centralized Ducting all Heat Registers
- Ceiling Fan with Light Kit
- Carbon Monoxide, LP, and Smoke Detector

### Appliances

- 13,500 Ducted Air (30'-38' Units)
- 15,000 Ducted Air (40'-44' Units)
- 40,000 BTU Furnace
- Residential Frost Free Refrigerator
- 20 Gallon Elec. Water Heater (PM FF Only)
- 20" Residential Range
- Lighted Range Hood
- Vent Fan with Switch
- Black Appliances

### Misc Other Features

- 5/8 T&G Plywood Floors
- 2x4 Floor joists and 2x2 Wall Studs
- Engineered Truss Roof w/ 3/8 in. Decking
- Mirrored Wardrobe (Per Floor Plan)
- Crown Molding (Kitchen and Living Room)
- R-7 Insulation
- Overhead Cabinet above Front Bay and Side Sofa
- Desk with 3 Drawers and Overhead (Some Models)
- Congoleum Flooring
- Walk-in Closets
- Engineered Truss Roof System

## BRIDGEVIEW OPTIONAL FEATURES

### Exterior Options

- Fiberglass Exterior
- Swing Out Grab Handles (Each)
- Triple Step (Each)
- Double Insulation
- Bubble Wrap (Foil)
- TV Antenna with Booster
- Rolled Metal
- Awning 14' - 25' Roll (Out)
- Awning Center Support
- Power Awning
- Large Trunk Door

### Windows and Doors

- Full Bay Front (Bottles Inc)
- Rear Bay Window
- Dual Pane Windows
- Skylight in Shower

### Electrical

- Fireplace with Remote
- Additional Ceiling Fan with switch
- Satellite Prep (Each)
- Phone Jack
- Max Air Vent w/ Wall Cradled Remote

### Furniture

- Bar Stools (Each)
- Magazine Rack/Table
- Hide-a-Bed
- Soft-Touch Recliner

### Interior Options

- Solid Surface Counter Tops
- Upholstered Box Valances
- Day & Night Shades
- Adjustable Pantry Shelves
- Slide Out Pantry
- Full Lino. Through Out
- Flip-Up Counter Top Extension
- Sink Cover

### Bedroom

- Movable Bed Box
- Bed Lift
- Drawers Under Bed (Each)

### Appliances

- Second Air Conditioner
- 15,000 BTU A/C
- Ice Maker
- Stainless Steel Package
- Microwave
- Dishwasher
- Washer Dryer Prep
- Washer and Dryer (110V)
- 20 cu. ft. refrigerator
- 10 Gal. Gas/Electric Water Heater w/ DSI

### Bath

- Self Contained Toilet w/1 or 2 Tanks
- Radius Shower with Glass Door
- Handicap Accessories

### Cabinetry

- Cherry Cabinets
- Extra Overhead

### Entertainment

- Flat Screen HDTV
- DVD with sound bar

### Misc.

- Push Out Stabilizer Bars
- Some Floor Plan Modifications Allowed
- Floor Plan Flip End to End
- Floor Plan Flip Side to Side (except 1K)
- Fresh Water Tank with Pump

## YOUR NEAREST BRIDGEVIEW DEALER:

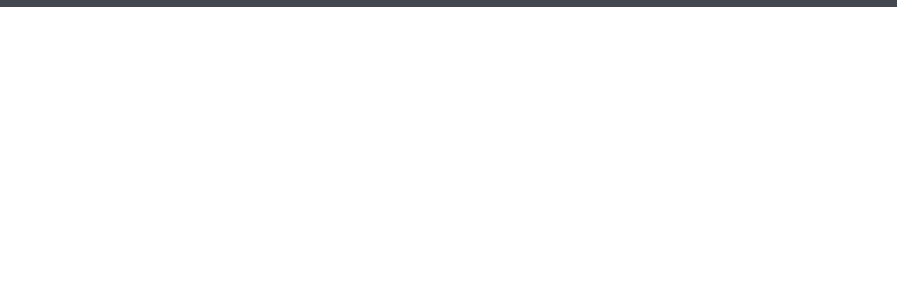

5321 Beck Drive  
Elkhart, IN 46516  
Phone: 800-645-6130  
Fax: 574-293-4672  
www.hlenterpriseinc.com

Due to our continuing efforts to improve our products, all prices and specifications are subject to change without notice. For available options and pricing, consult your nearest dealer.



Bridgeview  
by HL Enterprise, Inc

NEW  
FULL  
FIBERGLASS  
FRONT

Our newly offered Master bedroom incorporates the modern design of curved walls, large accessible closets and a bay window making this space as functional as it is attractive.

# Featured Floor Plans



Walk-in closet

After a long day, relax in one of our spacious bedrooms. Bridgeview offers many different configurations- just pick one to suit your lifestyle. Sweet dreams!



Shower with skylight



Fiberglass tubs and showers featuring residential fixtures

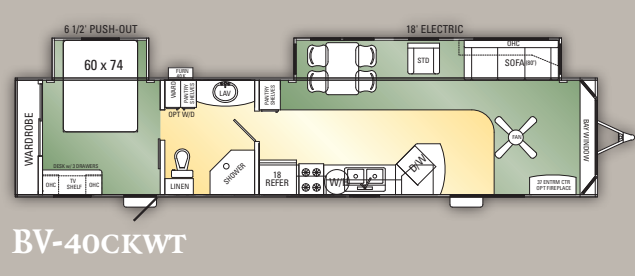
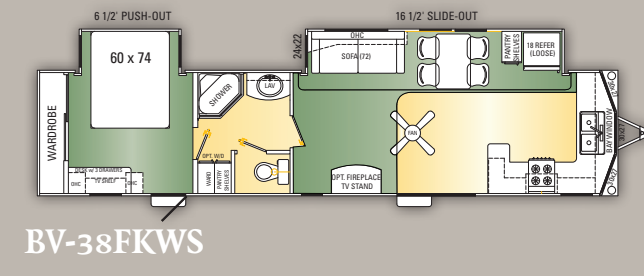
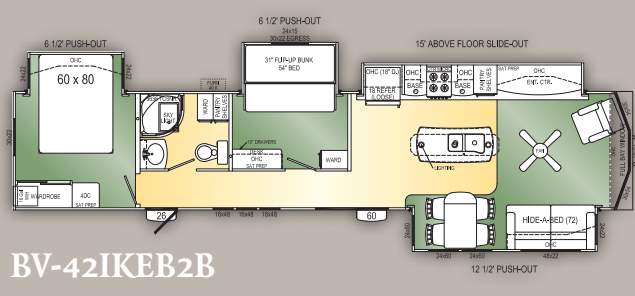
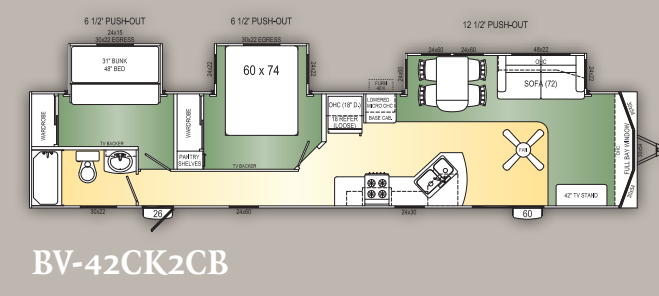
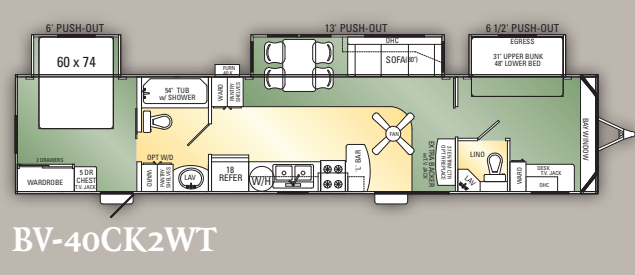
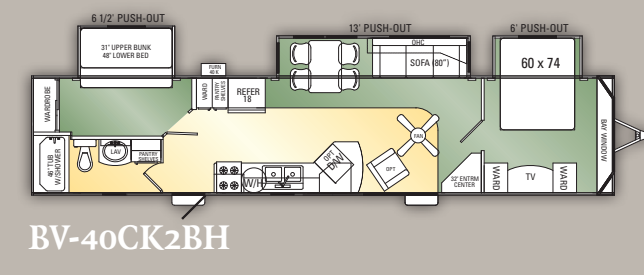
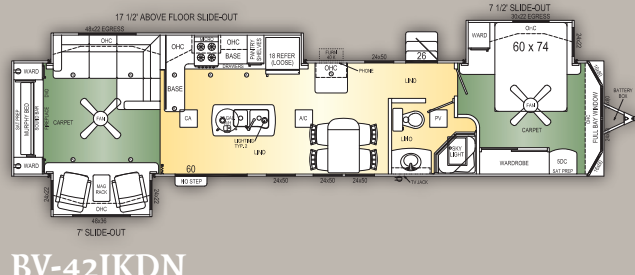
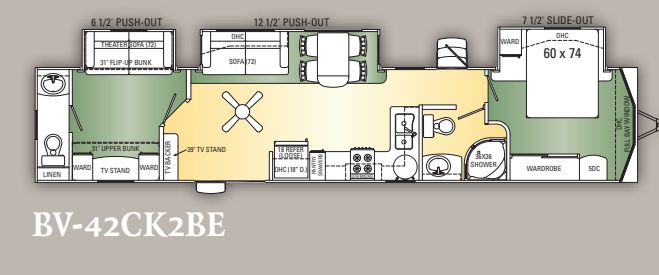
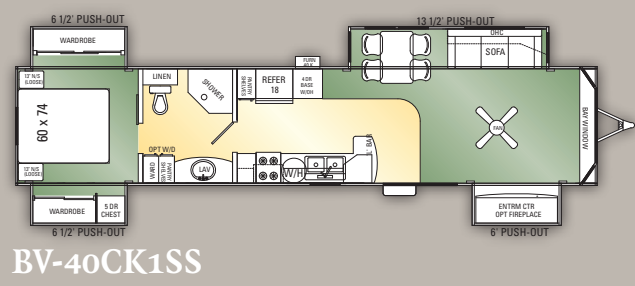
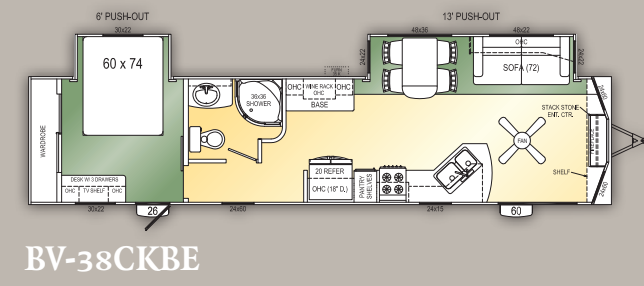
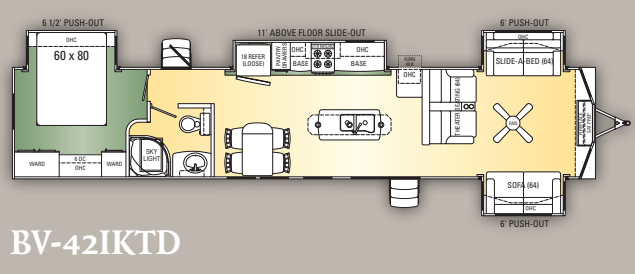
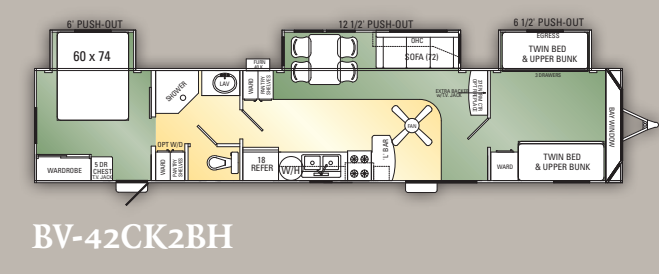
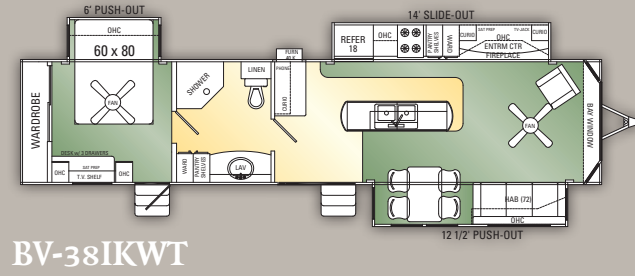
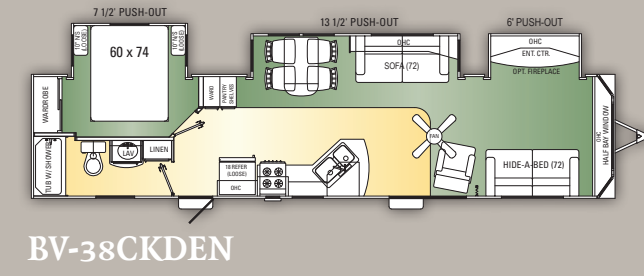
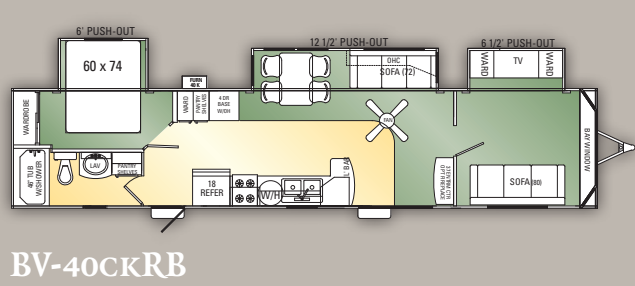
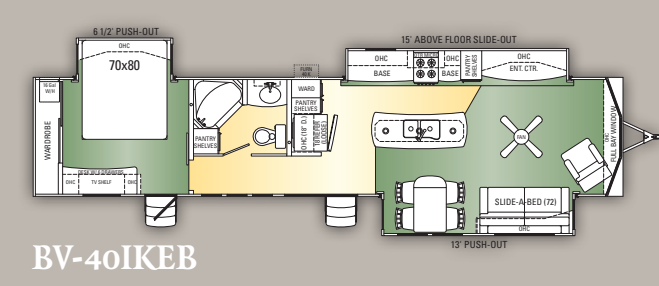
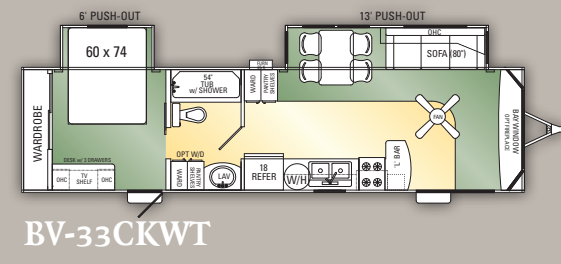
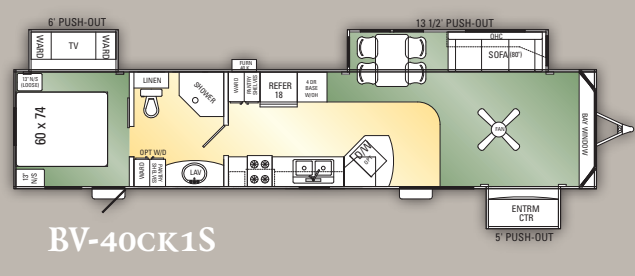
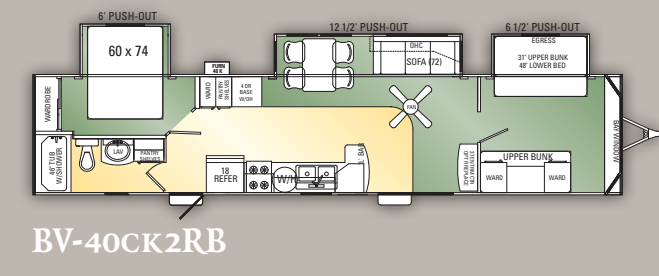
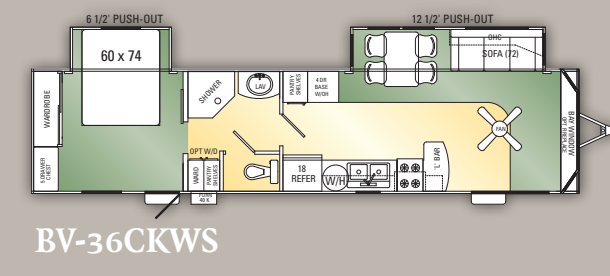
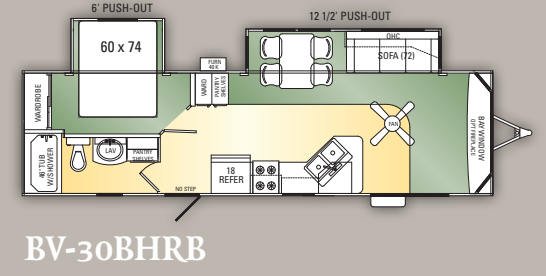

## Decor Options

A broad selection of furniture fabric and flooring choices allow you more flexibility to get the look and feel that is perfect for you. See your dealer or visit our website at [www.hjenterpriseinc.com](http://www.hjenterpriseinc.com) and search under the brochure tab to see the latest available fabric and flooring options.